

CURRENT TRANSDUCERS

DC CURRENT TRANSDUCER

MODEL CTG

FEATURES / APPLICATIONS

- Non-Contact DC Measurement
- Split Core Option
- Input/Output isolation
- Current Ranges 100A - 5000A DC
- Low DC Power Requirements



Rectangular Window Model



Circular Window Model

SPECIFICATIONS

INPUT

Current..... See Table..... DC/Peak AC
 Over Current Without Damage..... 10 X Rating @60Hz
 Instrument Power..... Operating Range $\pm 13\text{Vdc}$ to $\pm 18\text{Vdc}$
 Instrument Current..... $< \pm 20\text{mAdc}$
 Dielectric Test (conductor through window/output)..... 2200Vac
 Sensor size "D" and "E" (split core) 1000Vdc
 Frequency Response..... dc - 400Hz

OUTPUT

Signal..... $\pm 5\text{V}$ or $\pm 10\text{V}$
 Bi-directional Yes
 Load on Output $> 25\text{K}\Omega$
 Response..... Typ..... 500 μs
 Saturation..... Approx. 13.5V @ $\pm 15\text{Vdc}$ inst. pwr.

ACCURACY & LINEARITY $\pm 1.0\%$ F.S.
 Temp. Effects (0°C to +40°C) $\pm 0.05\%$ /°C

Note: The output is proportional in direction and magnitude from the input current

AVAILABLE OPTIONS

Power Supply $\pm 15\text{Vdc}$ TMP15215C
 Split Core Add the suffix "S" to the part number
 Extended Temp. Range (-20°C to +60°C)
 Add the suffix "T" to the part number

ORDERING INFORMATION

Example: 100A, Split Core with a $\pm 5\text{V}$ Output
CTG-101X5S

**Sensor size "D" split-core models are not UL listed.

APPLICATION AND ORDERING DATA			
CURRENT RANGE	$\pm 10\text{Vdc}$ OUTPUT	$\pm 5\text{Vdc}$ OUTPUT	SENSOR SIZE
0-100A	CTG-101	CTG-101X5	D**
0-200A	CTG-201	CTG-201X5	D**
0-300A	CTG-301	CTG-301X5	D**
0-400A	CTG-401	CTG-401X5	D**
0-500A	CTG-501	CTG-501X5	E
	CTG-501FS	CTG-501FSX5	F
	CTG-501HS	CTG-501HX5S	Z
0-600A	CTG-601	CTG-601X5	E
	CTG-601FS	CTG-601FSX5	F
	CTG-601HS	CTG-601HX5S	Z
0-800A	CTG-801	CTG-801X5	E
	CTG-801FS	CTG-801FSX5	F
	CTG-801HS	CTG-801HX5S	Z
0-1000A	CTG-102	CTG-102X5	E
	CTG-102FS	CTG-102FSX5	F
	CTG-102EES	CTG-102EESX5	EE
	CTG-102HS	CTG-102HX5S	Z
0-1500A	CTG-152	CTG-152X5	E
	CTG-152FS	CTG-152FSX5	F
	CTG-152EES	CTG-152EESX5	EE
	CTG-152HS	CTG-152HX5S	Z
0-2000A	CTG-202	CTG-202X5	E
	CTG-202FS	CTG-202FSX5	F
	CTG-202EES	CTG-202EESX5	EE
	CTG-202HS	CTG-202HX5S	Z
0-2500A	CTG-252	CTG-252X5	E
	CTG-252FS	CTG-252FSX5	F
	CTG-252EES	CTG-252EESX5	EE
0-3000A	CTG-302EES	CTG-302EESX5	EE
	CTG-302HS	CTG-302HX5S	Z
	0-4000A	CTG-402HS	CTG-402HX5S
0-5000A	CTG-502HS	CTG-502HX5S	Z

DIMENSIONS

CONNECTIONS

Case D & E

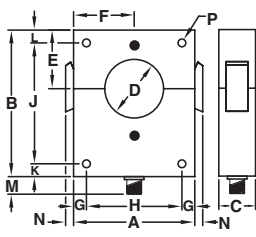

Case EE & F Split Core

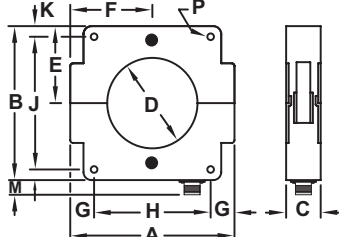

Case Z

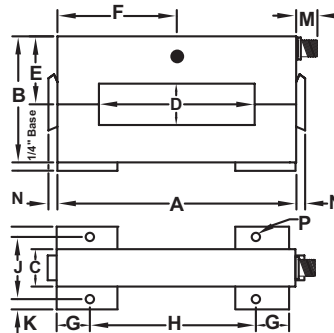

* For positive output, positive current conductor through "Red Dot" side of sensor.

TABLE 1 SENSOR SIZES D, Z

TABLE 1 SENSOR SIZES D, Z			
Plastic Connector			
8' Rubber Cable			
Pin Leads			
1 WHITE	-	OUTPUT*	
2 GREEN	+		
6 BLACK	-15V		
8 RED	+15V	Inst. Power	
1 WHITE	COM		

TABLE 2 SENSOR SIZES E, EE, F

TABLE 2 SENSOR SIZES E, EE, F			
Metal Connector			
8' Rubber Cable			
Pin Leads			
A WHITE	-	OUTPUT*	
B GREEN	+		
C BLACK	-15V		
D RED	+15V	Inst. Power	
A WHITE	COM		

SENS. SIZE	SENSOR DIMENSIONS (INCHES)														WT. LBS.
	A	B	C	D	E	F	G	H	J	K	L	M	N	P	
D	3 1/8	4	3/4	1 1/8	1 1/2	1 9/16	1/2	2 1/8	NA	1/2	NA	1/2	1/4	11/64	.75
E	4 1/8	5	1 1/4	2	2	2 1/16	7/16	3 1/4	4 1/8	7/16	7/16	5/8	5/16	17/64	2
F	5 3/8	5 1/4	1 5/8	2 1/4	2 5/8	2 11/16	1 1/16	3 1/4	4 1/8	9/16	NA	5/8	NA	1/4	2.8
EE	7 3/4	7 1/4	1 5/8	4 1/4	3 5/8	3 7/8	1 1/8	5 1/2	6 1/4	1/2	NA	5/8	NA	5/16	4.5
Z	7 3/16	3 3/4	1 5/16	1 1/4 X 4 1/2	2 9/64	3 1/2	1	5	1 7/8	5/16	NA	5/16	1/4	3/16	2.8

FLEX-CORE®

Div. Morlan & Associates, Inc.

4970 Scioto Darby Rd. Hilliard, Ohio 43026

WWW.FLEX-CORE.COM

sales@flex-core.com

PHONE (614) 889-6152

TECH. ASSISTANCE (614) 876-8308

FAX # (614) 876-8538